

Number of stays chart - L 164 mm

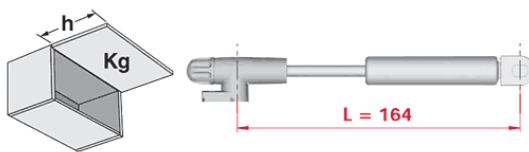

Rev. 02

h	Kraby version	Door weight (Kg)										Kraby version
		1	2	3	4	5	6	7	8	9	10	
230 - 274	Automatic	1x80N	2x80N	2x120N		3x120N			4x120N			Automatic
	Friction	1x45N	2x45N			2x60N			3x60N			Friction
275 - 325	Automatic	1x80N	2x80N	2x120N		3x120N			4x120N			Automatic
	Friction	1x60N	2x45N		2x60N		3x60N		4x60N			Friction

Number of stays chart - L 244 mm

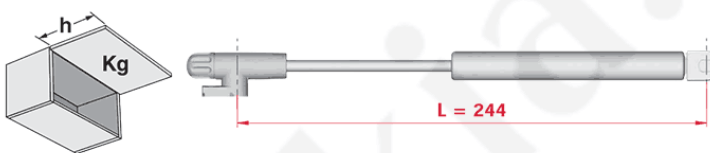

Rev. 02

h	Kraby version	Door weight (Kg)													Kraby version
		1	2	3	4	5	6	7	8	9	10	11	12	13	
300 - 324	Automatic	1x80N		2x50N		2x80N		2x100N		2x120N		2x140N	2x160N*		Automatic
	Friction	1x45N		1x60N	2x45N			2x60N			2x90N				Friction
325 - 374	Automatic	1x80N		2x50N	2x80N		2x100N	2x120N		2x140N	2x160N*		2x180N*		Automatic
	Friction	1x45N	1x60N	2x45N		2x60N			2x90N			2x120N			Friction
375 - 424	Automatic	1x80N	2x50N	2x80N		2x100N		2x120N	2x140N	2x160N*		2x180N*	2x240N*		Automatic
	Friction	1x45N	1x60N	2x45N		2x60N			2x90N			2x120N			Friction
425 - 474	Automatic	2x50N		2x80N		2x100N		2x120N	2x140N	2x160N*		2x180N*		3x160N*	Automatic
	Friction	1x60N		2x45N		2x60N		2x90N			2x120N		3x90N		Friction
475 - 524	Automatic	2x80N		2x100N		2x120N	2x140N	2x160N*		2x180N*		3x160N*			Automatic
	Friction	2x45N		2x60N		2x90N		2x120N	3x90N		3x120N			Friction	

* Strengths available on request.

Number of stays chart - L 355 mm



Rev. 02

h	Kraby version	Door weight (Kg)													Kraby version
		1	2	3	4	5	6	7	8	9	10	11	12	13	
400 - 424	Automatic	1x80N		2x50N		2x80N			2x100N		2x120N		2x160N		Automatic
	Friction	2x45N						2x60N						Friction	
425 - 474	Automatic	1x80N		2x50N	2x80N		2x100N		2x120N		2x160N				Automatic
	Friction	2x45N						2x60N			2x90N				Friction
475 - 524	Automatic	1x80N		2x50N	2x80N		2x100N		2x120N	2x160N		2x180N		2x200N	Automatic
	Friction	2x45N						2x60N			2x90N				Friction
525 - 574	Automatic	1x80N		2x50N	2x80N		2x100N	2x100N	2x160N			2x180N		2x200N	Automatic
	Friction	2x45N						2x60N			2x90N				Friction
575 - 624	Automatic	2x50N		2x80N	2x100N		2x120N	2x160N			2x180N	2x200N			Automatic
	Friction	2x45N						2x60N			2x90N				Friction
625 - 700	Automatic	2x50N		2x80N	2x100N		2x120N	2x160N			2x180N	2x200N			Automatic
	Friction	2x45N			2x60N			2x90N		2x120N				Friction	

These are experimental results to be checked by the customer. Our Technical Department is at your disposal to test further cases out of this charts.



KRABY CONFIGURATOR:



LIFT UP DRILLING PLANS WITH STANDARD HINGES
OPENING WITH HANDLE

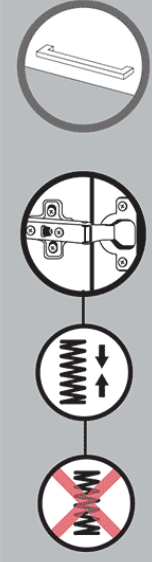

L 164 mm

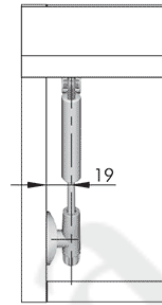
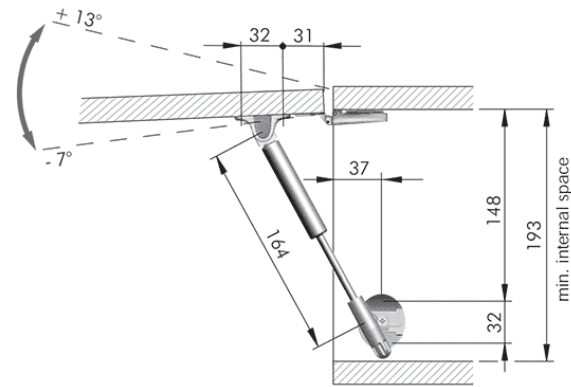

L 244 mm

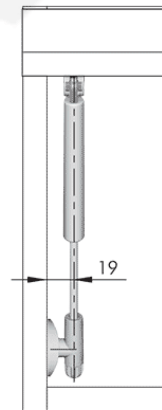
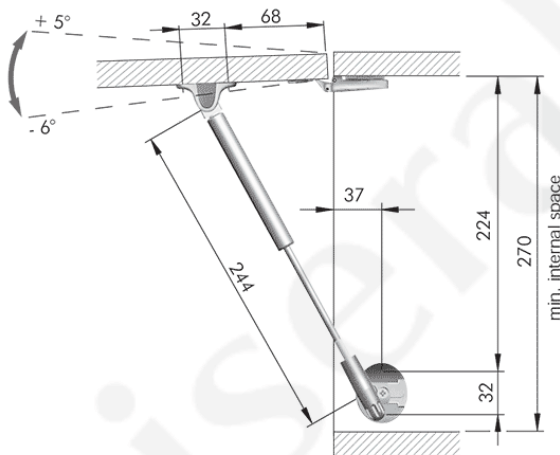

L 355 mm

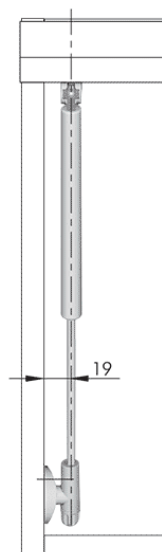
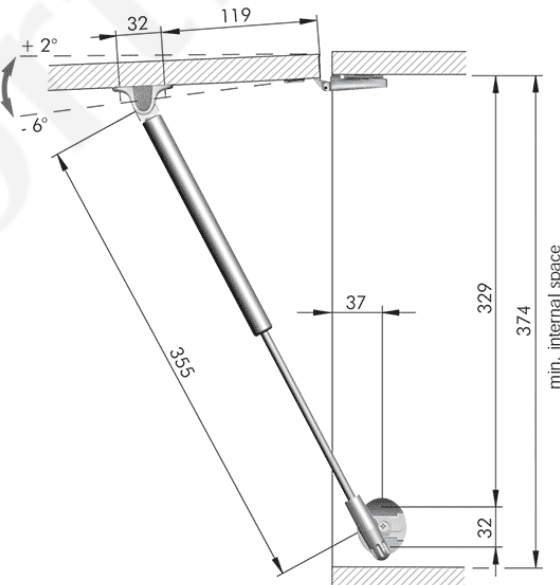

The dimensions of the above drilling plans refer to carcasses which use **standard sprung or unsprung hinges** and mounting plates 0 mm. Please note that the opening angle shown data is purely indicative. It varies with respect to the hinge brand and adjustment carried out.



Please note that in case of use of **unsprung hinges**, magnet K Lock is required. For details refer to section "PUSH CATCHES & MAGNETIC CATCHES".

LIFT UP DRILLING PLANS WITH STANDARD HINGES PUSH TO OPEN

KRABY CONFIGURATOR:



L 164 mm

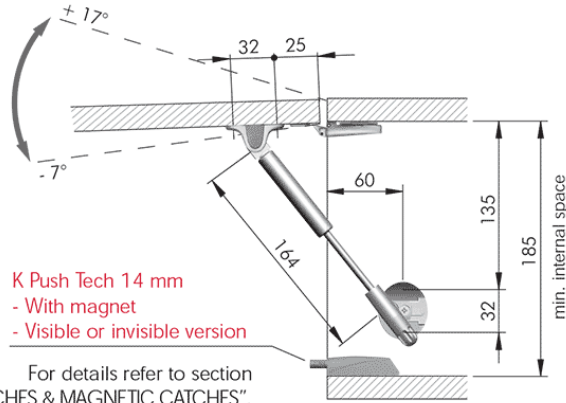

K Push Tech 14 mm
- With magnet
- Visible or invisible version

For details refer to section "PUSH CATCHES & MAGNETIC CATCHES".

L 244 mm

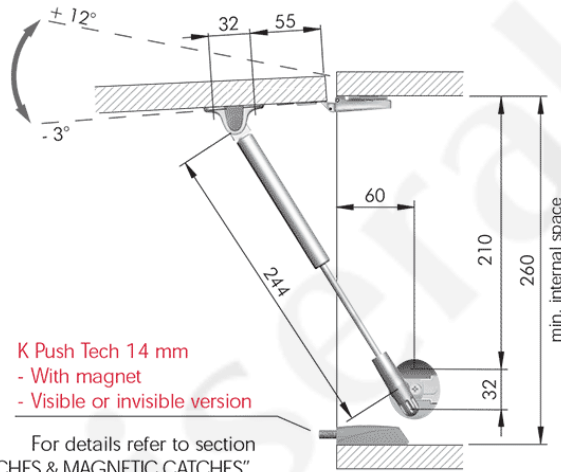

K Push Tech 14 mm
- With magnet
- Visible or invisible version

For details refer to section "PUSH CATCHES & MAGNETIC CATCHES".

L 355 mm

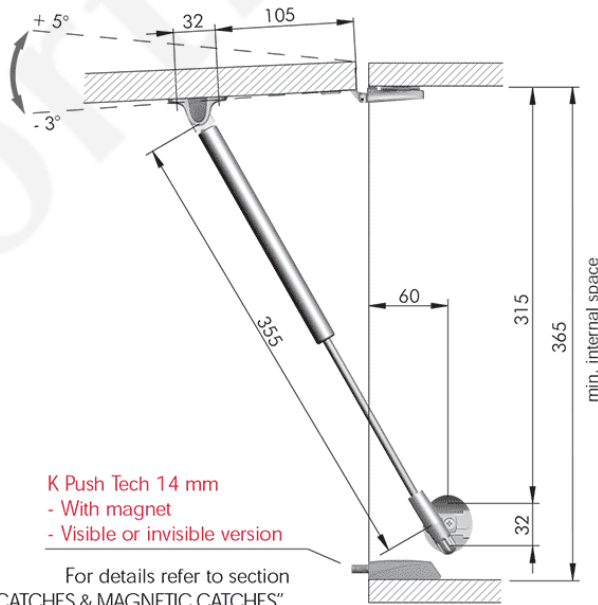

K Push Tech 14 mm
- With magnet
- Visible or invisible version

For details refer to section "PUSH CATCHES & MAGNETIC CATCHES".

The dimensions of the above drilling plans refer to carcasses which use **standard unsprung hinges** and mounting plates 0 mm. Please note that the opening angle shown data is purely indicative. It varies with respect to the hinge brand and adjustment carried out.



Please note that utilization with **standard sprung hinges** and **K Push Tech with buffer** is also possible. In such case, after the door is initially released by K Push Tech, a manual opening approx. 7cm is required (in order to win the spring resistance). Consequently, the door will automatically open to the fullest.
For details refer to section "PUSH CATCHES & MAGNETIC CATCHES".

KRABY SYSTEM LIFT UP

KRABY is a gas and oil stay to open flap doors. It has been conceived to be installed by using standard automatic drilling processes. It is available in three different lengths and several newton strengths to suit doors of any size. It can be fixed directly on solid doors or wider aluminium frame section doors. For small aluminium sections a range of special adaptors is available. KRABY is available in:

- Automatic version: once you open the door, it continues to open gently and completely by itself.
- Friction version: once you open the door, the stay holds the door in any required position.

KRABY offers some relevant benefits:

- The rotary knob placed on the piston base plate can be used to adjust the opening angle and therefore to align nearby doors.
- By adjusting the position of the piston base plate within the "U" slot of the side bracket, it is possible to change the time in opening and closing of the door

All the parts (stay excluded) are in zinc alloy nickel plated and engineering plastic.

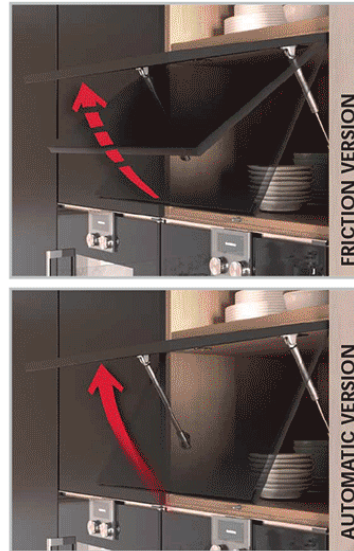

PATENTED
Certificates available
on request.



INSTALLATION



VERY IMPORTANT

The door bracket has to be placed in vertical position with the slot facing forwards.

recommended fixing countersunk head wood screws $\varnothing 3,5 \times 16$ mm or Euro thread screws.

VERY IMPORTANT

The side bracket has to be placed with the slot in horizontal position and the open end facing the wall.

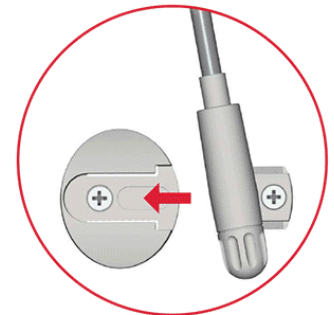
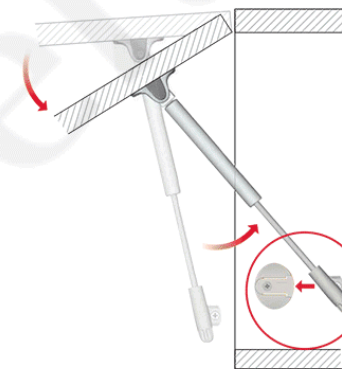
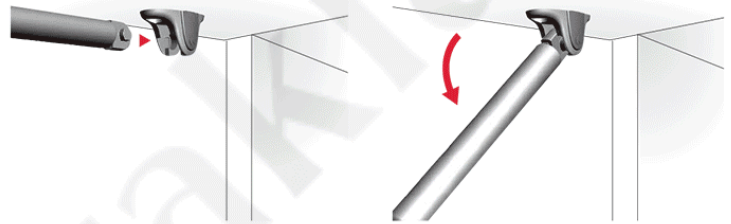
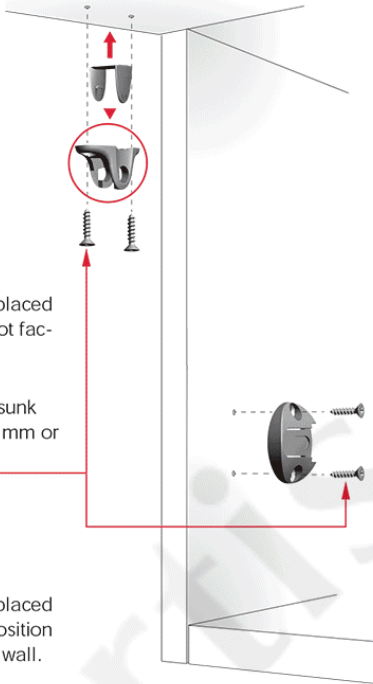

ADJUSTMENTS

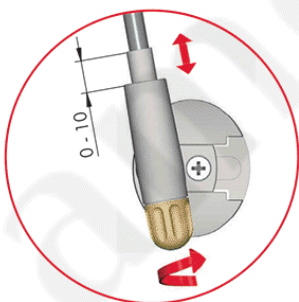

INCREASE OPENING ANGLE

Rotate the rotary knob.

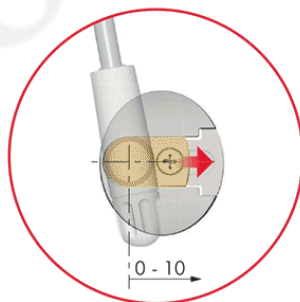

REDUCE OPENING ANGLE

Move forward and backward the piston base plate in the bracket slot.

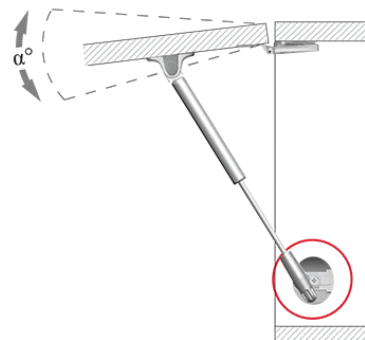

LOCKING

